

FLOORING SOLUTIONS FOR
Hospitality

DISCOVER OUR STYLISH
RANGE OF FLOORS
AND HOSPITALITY
SOLUTIONS.

QUEST ROOMS
P. 16

2ND FLOOR

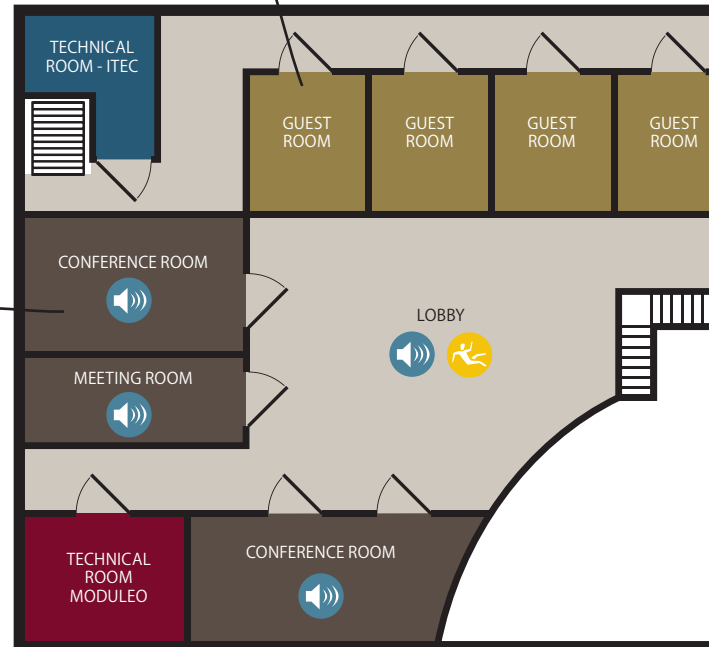

MEETING &
CONFERENCE
ROOMS
P. 20



1ST FLOOR

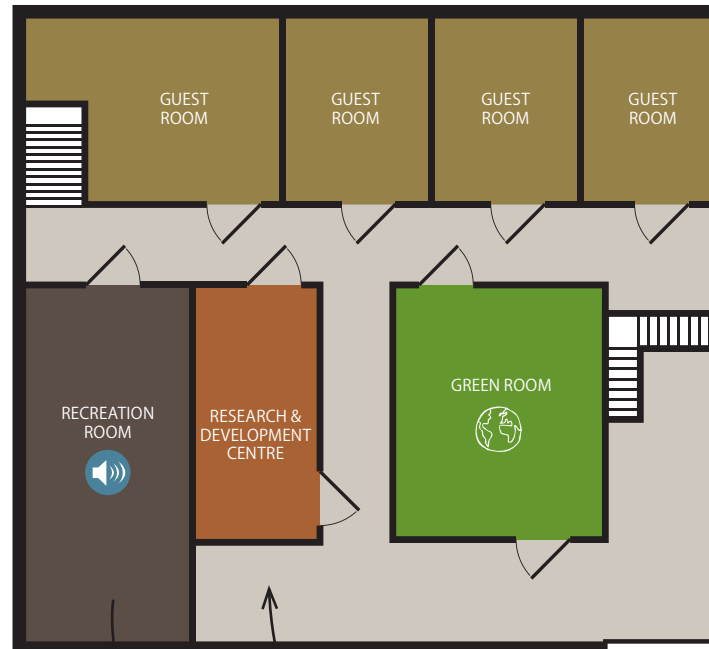

RECREATION
ROOM
P. 20

R&D
P. 26



Content

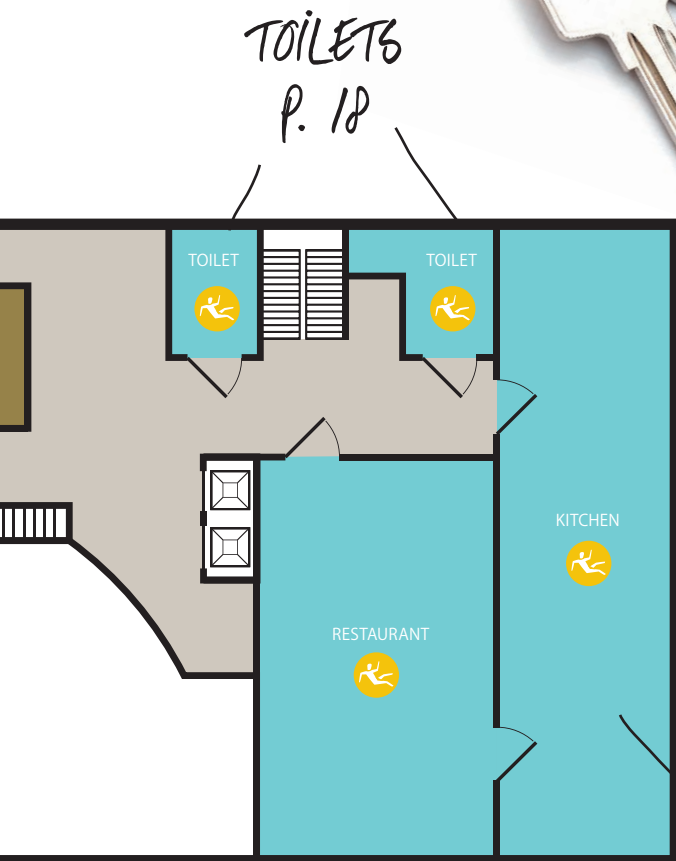

ENTRANCE HALL
P. 14

BAR & RESTAURANT
P. 18



IVC Group
A Solid Company
04



Moduleo Commercial Flooring
Modular Planks & Tiles
06



Itec Commercial Flooring
Contract Vinyl on Rolls
08



Acoustic Flooring Solutions
10



Safety Flooring Solutions
12



Technical Specifications Moduleo
22



Technical Specifications Itec
24



Research & Development Centre
26



Green Policy
28



Meeting International Standards & Norms
30



A Solid Company



IVC Group HQ, Avelgem, Belgium

The IVC Group was established in 1997 and quickly developed into an independent powerhouse in the market of synthetic flooring solutions.

Originating in Belgium, the IVC Group is currently active and producing on two continents, delivering first-rate products and services to more than 100 countries around the world. As Europe's

residential market leader in resilient flooring and a world-class manufacturer of premium vinyl, laminate and LVT flooring products for residential and commercial applications, IVC strives to satisfy the demands of its customers and partners in each stage of the game.

Every day, the more than 1.320 members of the IVC Group family bring to life our company creed ('never rest on your laurels') and commitment to a unique range of floors that were designed to set trends and inspire confidence and style.

At IVC Group, we presume nothing and pay attention to everything, and that has allowed us to break the mould for more than 15 years.

Dedicated service

Hospitality projects are never straightforward, as they involve many stages and stakeholders. In such a context, service is key. With the IVC Group, you will get a catalogue of diverse flooring products and one easy point of access and contact. Our hospitality consultants will also make sure that your choice of floor meets health and safety requirements and complies with current legislative and environmental codes.

A trustworthy partner for collaborations that deliver results

The IVC Group does more than just supply floors. In every stage of the process, and in every room and space, we propose tailor-made solutions that match the unique vision of our partners. Always painting the picture in full, the IVC Group has not only become a residential market leader but we also aspire to build up the same credentials and experience towards commercial flooring projects.

The IVC Group offers a tried and tested blend of quality and elegance that readily corresponds to the specific functions and detailed specifications of your next development or refurbishment. And all your employees, customers and guests will enjoy the practical benefits and the aesthetic freedom our collections afford.

Working in close rapport with architects, project developers, contractors and local stakeholders, our experts are able to help bring your next hospitality project to life, with floors that put the finishing touch to every room and space.

Because at IVC Group we believe in flooring solutions that build sustainable visions from the ground up.

Why Work with the IVC Group?

- I Top-quality products that meet the highest standards
- II A long tradition of innovation in flooring solutions
- III An extensive choice in floor specs and product designs
- IV Fashion-forward collections that capture today's market trends
- V A portfolio of strong international brands
- VI Robust technical knowhow and industry expertise
- VII Hands-on customer services and dedicated sales team
- VIII Reliable and responsive collaborations and partnerships
- IX A huge own production capacity guaranteeing fast worldwide delivery
- X A socially responsible and sustainable outlook on the world of flooring

Because as your next project partner, we offer:

Moduleo® Commercial Flooring Modular Planks & Tiles



Moduleo Transform Jura Stone 46840

What?

Moduleo specialises in the development and production of high-quality, modular vinyl floors for **residential and commercial use**. Offering a diverse range of stylish planks and tiles with unparalleled 'green' credentials, Moduleo is an industry-expert in natural-looking and durable luxury vinyl flooring.

All Moduleo products are available in a click version (floating installation) and in a dryback version (adhesive required).

Composition

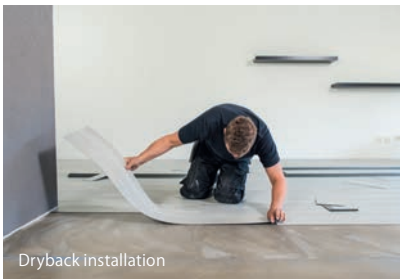
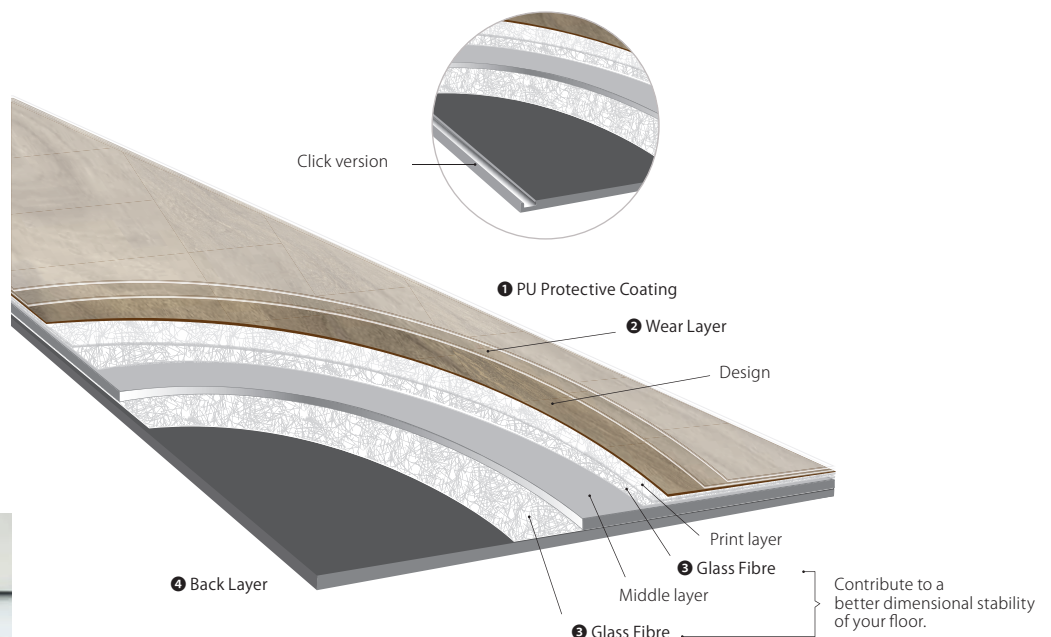

Dryback installation

Composition

Thanks to its unique composition, a Moduleo plank or tile offers many advantages to its users. The glass fibre and synthetic layers safeguard your dimensional floor stability, while the wear layer guarantees a long and low-maintenance life. In addition, all our products have a Protectonite® PU protective coating that offers extra resilience against scuffs and scratches, as well as a moisture-resistant and uniquely textured finish.

- ❶ PU protective coating: offers extra resilience against scuffs and scratches, as well as a moisture-resistant and premium finish with added texture which contributes to the natural look of our plank and tiles.
- ❷ Wear layer: first protective layer on top of the printed design.
- ❸ Glass fibre layers: contribute to a better dimensional stability of your floor.
- ❹ Back layer: a sound absorbing back layer that, thanks to its refined texture, contributes to an easy installation of our Moduleo planks and tiles.



Moduleo Impress Eastern Hickory 57422



Moduleo Transform Blackjack Oak 22215

Collections

Select

Beautiful and durable, Select is ideal for any area of the family home. Combining the natural look of stone and wood with the durability of vinyl technology, Select is scuff-proof with a Protectonite® PU protective layer, moisture-resistant (making it ideal for kitchens and bathrooms) and easy to clean. Select can deal with even the most demanding environments and comes with a 7-year commercial warranty.

Transform

The Moduleo Transform range features a hard-wearing top layer, making it ideal for commercial as well as domestic applications. Available in wood and stone effects, Transform features a thick Protectonite® PU coating that is easy to clean, ensuring that your floor is well-protected from scuffs and stains. Transform is moisture-resistant and has an anti-slip rating of R10.

Impress

Our latest collection's name immediately makes clear what the collection represents: a truly unique impression. Moduleo Impress, an exclusive concept of modular vinyl floors for residential and commercial use, bringing to life the authenticity and detailed refinement of wood with character, is a tribute to the beauty of nature. The 'Embossed in register' procedure contributes to the true-to-nature look and feel of the Impress floors. The result? An answer to all contemporary interior decorating trends and needs of the contract market (for instance a 0.55mm wear layer and a 10-year commercial warranty). In short: a floor that impresses.

Select, Transform and Impress are delivered with ISO 9001, ISO 14001, BRE A+ rating, A+ Indoor Air Quality (IAQ) & BREEAM accreditation.



Itec Concept Toronto 699

What?

Itec produces heavy-duty vinyl floors on 2, 3 and 4m rolls for the contract and semi-contract market, meeting the most exacting market demands in terms of build quality, health and safety and the environment. Itec is an expert in safety and acoustic flooring and aims to produce first rate vinyl floors that can match any commercial application or setting. Itec Isafe floors (see page 12) are designed to withstand high levels of foot traffic and come with a permanent slip resistance to provide style, stability and unrivalled safety in the most demanding circumstances. Our acoustic ranges (see page 10), for their part, offer carpet-like quiet thanks to their padded back, which is also a great thermal insulator. This results in an impressive reduction of footfall and ambient noises.

Composition

Itec® EN 649 Decorative

Planet, Penta, Atom, Concept

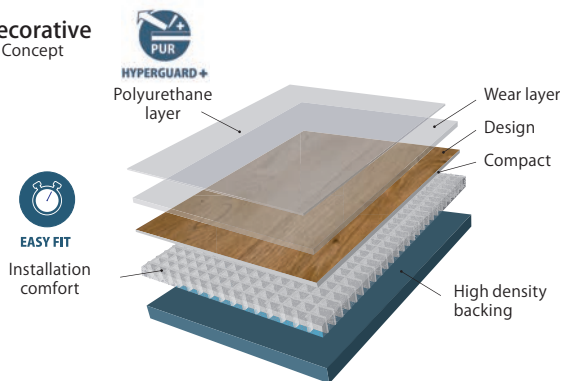

Itec® EN 649 Safety

Isafe one, Isafe apex

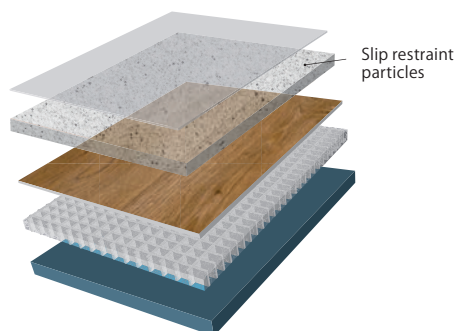

Itec® EN 651 Acoustic

Batirox, Silento, Axento, Optimise

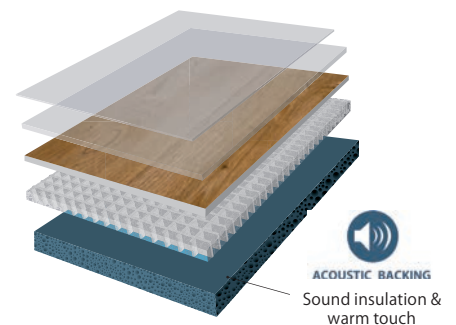

A fitting solution for every commercial project

Whether you have a project in healthcare, education, hospitality or office building, Itec has the perfect flooring solution tailored to your specific requirements and needs. Furnishing rooms with high-grade performance floors, we aim to inspire wellbeing and comfort around the house, and around the clock.



Itec Isafe Camargue 555



Itec Planet Marble 678



Itec Concept Calais 645

Next to Hospitality floors, we also offer high-level flooring solutions for:

- Health & Care
- Education
- Office building
- Social housing
- Retail
- ...



Acoustic Flooring Solutions



Itec Optimise Camargue 604

Comfort, harmony & tranquility

Everyone loves spending the night in a quiet hotel or B&B, a home away from home, where people might put up their feet and relax. Noise can be a real annoyance when you are enjoying the privacy and comfort of your room. To avoid excessive sound pollution from the adjacent rooms and hallways – and to avoid neighbourly rows – it is

best to fit the room with an acoustic performance floor.

There are basically two types of sound that can penetrate the room's environment: impact sound and ambient sound.

Impact sound is a fact of a hotel room's everyday life: as foot traffic

connects with the surface of the floor, sound waves are sent up and down its spine. These waves are transmitted through the floor and make themselves heard in the hotel room below. Thanks to their high-density padding and class-leading insulation features, IVC Group's acoustic floors are able to reduce impact sound levels up to an impressive 20dB.



Itec Concept Santiago 749

The right acoustic floor covering acts as a buffer between the hotel guests' feet and the room's subfloor, which is typically made of concrete. Not only the thickness of the slab will determine how much noise is able to penetrate the barrier, but also the covering on top. With the right thickness, high-quality materials and performance specs, a floor covering can play a pivotal role in combatting the proliferation of sound and blocking out undue decibels. The IVC Group's collection of acoustic flooring, which are available in a

range of stylish decors, have been especially designed to reduce the impact sound, making for a pleasantly quiet living (and easy-listening) environment.

Our **acoustic floors** provide:

- an insurance policy against noise complaints from neighbours
- excellent insulation that muffles footfalls and ambient sounds in hallways
- stunning patterns and textures that make a real aesthetic impact
- a combination of features that work together to deliver outstanding results



Itec Concept Burgos 730

The IVC Group proposes:

itec® Contract Floors **BATIROX / SILENTO**
AXENTO / OPTIMISE 50/70

- ★ Excellent sound absorption (up to 20dB)
- ★ Padded backing for thermal comfort
- ★ Carpet-like quiet with hypoallergenic benefits
- ★ Effortless installation
- ★ Sanitec treatment*

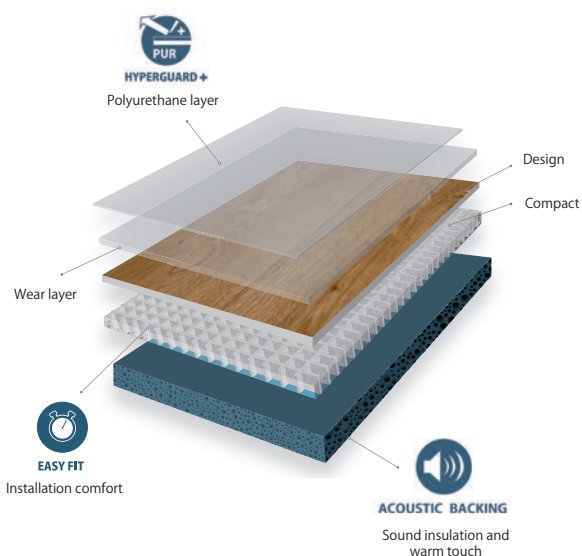

(*) On Optimise 50/70, Batirox

Noise reduction

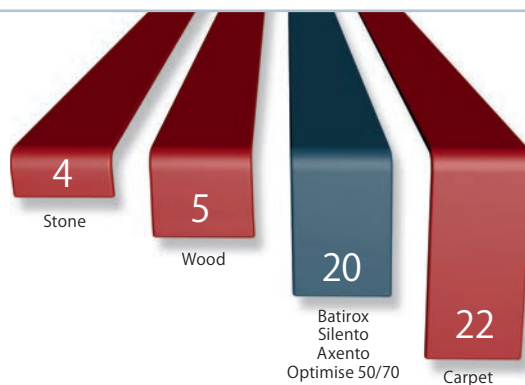

Impact & sound reduction in dB.



Safety Flooring Solutions

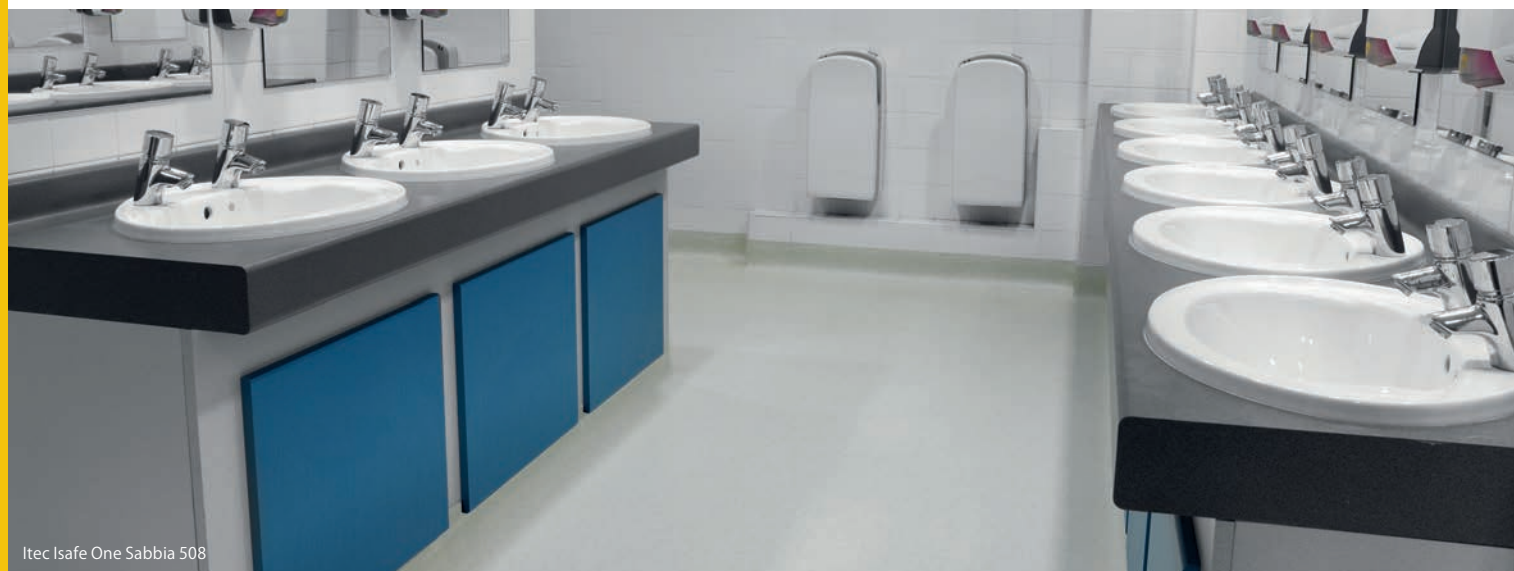

Paving your guests' way

Safety flooring reduces the risk of unexpected slips and accidents in areas that are naturally prone to wet or slippery circumstances. Bathrooms, lavatories, commercial kitchens, restaurants, bars, gyms, leisure areas, rooms that provide easy access to the minibar, ... these are the places where trip-ups do happen every once in a while.

IVC's safety flooring solutions were designed to resist slippages every step of the way, however wet it

might be. Thanks to its aggregate-enriched and extra thick performance layer, which improves the roughness of the floor surface without taking away from its smooth and stylish looks, these high-performance floors provide added comfort and grip, even to people going barefoot. The added friction and firmer foothold the Isafe collection affords does much to safeguard the wellbeing of your staff and guests alike, and their safety features are particularly

suited to children and the elderly or infirm. All of IVC's Isafe floors have been rigorously tested (see page 26) in our lab facilities and are ready to meet the most stringent health & safety standards in the market.

Our **safety floors** offer:

- surefooted comfort
- watertight protection in wet rooms

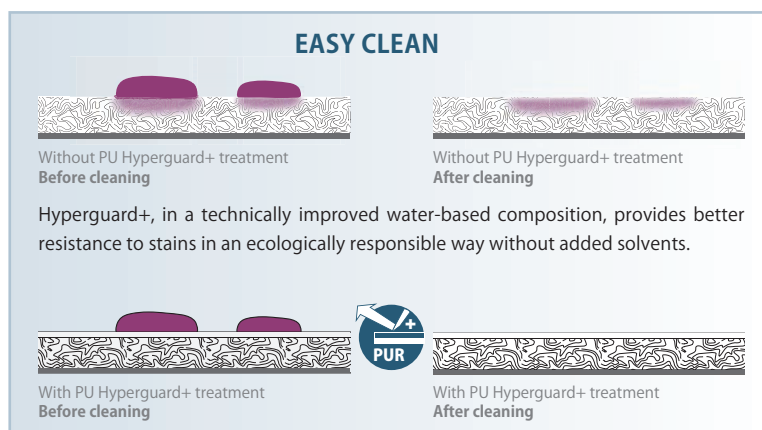

Surface roughness measurement [Rz]

The Surface Roughness Measurement suggests the slip potential of the floor in wet conditions

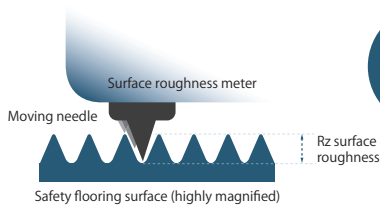

Isafe Safety Flooring = Low slip potential

Rz Surface Roughness	Slip Potential
Below 10 μm	High
10 - 20 μm	Moderate
20+ μm	Low

Pendulum test [BS 797-2:2002]

The Pendulum Test is the preferred measurement of the HSE (Health & Safety Executive)

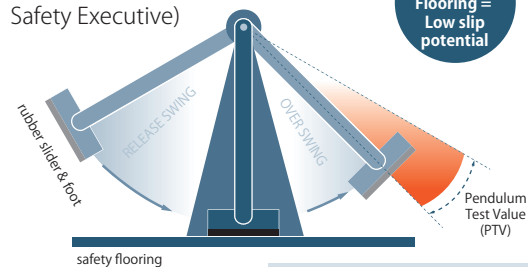

Isafe Safety Flooring = Low slip potential

	Pendulum Test Value
High Slip Potential	0-24
Moderate Slip Potential	25-35
Low Slip Potential	36+

The IVC Group proposes:

itec° ISAFE APEX / ONE
Contract Floors

- ★ Industry-tested performance features for advanced foothold and low potential for slips (up to 36+ TRRL - R11)
- ★ Beautiful collection of designs inspired by nature
- ★ High-calibre protection
- ★ Low-key maintenance
- ★ Easy to fit and ready to use in busy public areas

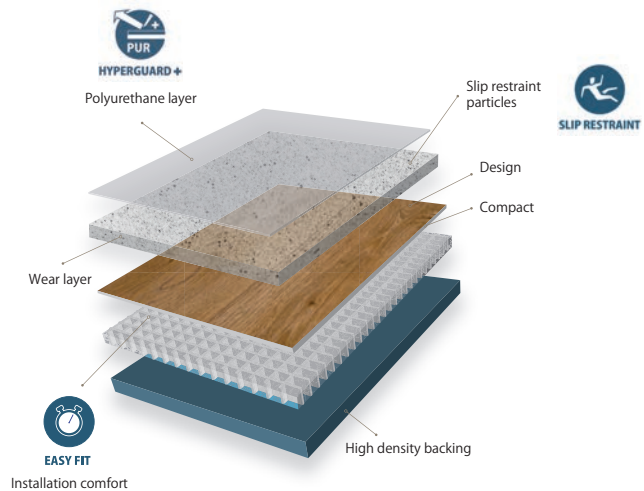

Ramp test

Slip Angle (°)	Classification
35+	R13
27 - 35	R12
19 - 27	R11
10 - 19	R10
6 - 10	R9

[DIN 51130:2010]

The Ramp test has become the most widely used slip resistance test

Isafe Safety Flooring = Classification R11

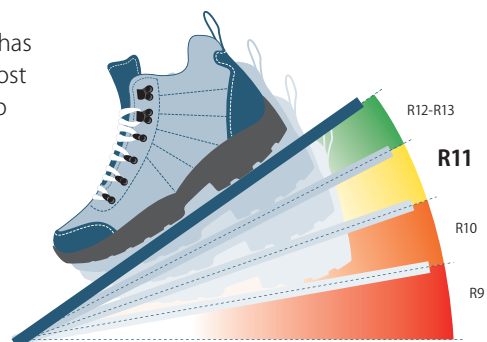

Entrance Hall



Moduleo Impress Country Oak 54880



Moduleo Transform
Steel Rock 46234



Moduleo Transform
Concrete 40945



Moduleo Transform
Verdon Oak 24885

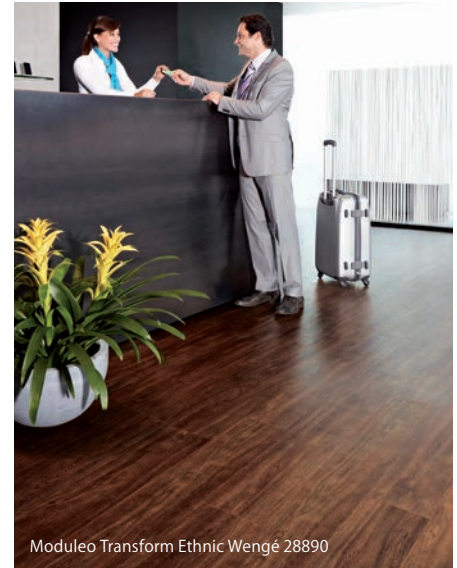

Moduleo Transform Ethnic Wengé 28890

The entrance hall

- is the first space your guests will see, so better make a good impression with our breath-taking designs.
- has lots of traffic to endure, so durable, hard-wearing flooring solutions are the way to go.
- is a public space, so health and safety are key considerations.
- tends to be a large space, so what you're looking for is an economical floor that can be easily installed.



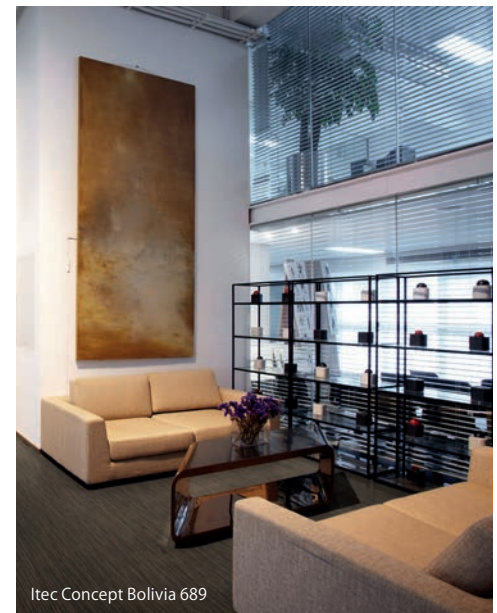

Itec Concept Bolivia 689



Itec Concept Camargue 603

Itec Concept Burgos 730



Itec Concept Bretagne 744

Itec Concept Equador 745



Itec Concept Papilio 697

Itec Concept Camargue 604

” The entrance hall has a great first impression to make on your guests

Moduleo Transform Concrete 40876

The IVC Group proposes:



- ★ A wide range of inviting colours and moods
- ★ Can deal with heavy traffic thanks to its Hyperguard+® protective wear layer
- ★ Very easy and economical to clean and maintain
- ★ Robust thermal and acoustic insulation
- ★ Strikes a perfect balance between comfort and elegance



- ★ Realistic, large and trendy designs with little repetition of the print and pattern
- ★ Easy installation & removal thanks to our patented CLICK technology (also available in dryback)
- ★ Scratch- and scuff-resistant thanks to its Protectonite® PU wear layer
- ★ Slip-resistant, with an anti-slip rating of R10
- ★ Safeguards the indoor air quality

Guest Rooms



Itec Optimise Navarra 694

The guest rooms

- should make the guests feel right at home.
- have a large impact on the impression the guests will have of your project.
- should be quiet, comfortable and warm, an oasis of peace.
- require a floor with an excellent sound absorption so neighbouring guests aren't disturbed.



Itec Optimise Rochus 694



Moduleo Transform Fazino Maple 28950



Moduleo Transform Ethnic Wengé 28282



Itec Optimise Pinnacles 634



Itec Optimise Pinnacles 645



Itec Optimise Toronto 681



” Comfortable and warm, an oasis of peace and quiet

Moduleo Transform Latin Pine 24142



Moduleo Transform Blackjack 22862

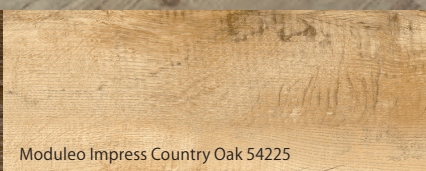

Moduleo Impress Country Oak 54225



Moduleo Impress Scarlet Oak 50274

The IVC Group proposes:



- ★ An attractive choice of natural designs
- ★ Strong thermal and acoustic (up to 19dB) qualities
- ★ Superior hygiene, effortless cleaning
- ★ Strikes a perfect balance between comfort and elegance



- ★ Chameleon designs that are distinctly not run-of-the-mill
- ★ Cushions sound and keeps the neighbours happy
- ★ Safeguards the indoor air quality
- ★ Protectonite wear layer for scuff and stain resistance delivering a 10-year commercial warranty against wear

Bar, Restaurant, Kitchen & Toilet



Moduleo Impress Castle Oak 55960

The bar, restaurant, kitchen and toilets are

- home to heat and moisture, which can result in damage and the proliferation of bacteria and mould.
- subject to spillages and splashes, so better opt for a moisture-resistant floor that's easy to clean.
- prone to slips and, hence, need safe flooring solutions.



Moduleo Impress Castle Oak 55935



Itec Planet Marble 635



Moduleo Transform Cotton Wood 20219



Itec Isafe Sabbia 518



Itec Isafe One Pizarra 593

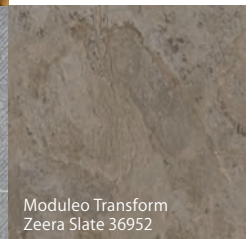

Moduleo Transform Zeera Slate 36952



Moduleo Impress Eastern Hickory 57885



Moduleo Transform Baltic Maple 28230



Moduleo Transform Concrete 40286



Moduleo Impress Scarlet Oak 50274

“ These rooms greatly benefit from a healthy and waterproof flooring solution that delivers extra comfort and grip

The IVC Group proposes:



- ★ Plethora of striking prints and designs
- ★ Hygienic, counteracting the growth of bacteria and mildew
- ★ Safe flooring solution, withstanding spillages and splashes
- ★ Slip-resistant, with a rating up to R11



- ★ Flexible, nature-inspired designs brimming with elegance and charm
- ★ Perfectly water-resistant thanks to its unique composition
- ★ Very easy and economical to clean and maintain
- ★ Scratch- and scuff-resistant thanks to its Protectonite® PU wear layer

Recreation, Meeting & Conference Room



Moduleo Impress Scarlet Oak 50 230

The recreation, meeting and conference rooms

- require a specific design adapted to the target group.
- are used regularly, so you'll want a heavy-duty floor that can be easily maintained.
- tend to be large, and spacious rooms solicit more economical floors.
- require safe, healthy and acoustic flooring solutions.

” Large, spacious rooms solicit more economical floors



Itec Concept Raffia 32

Itec Concept Raffia 646

Itec Concept Raffia 632

Itec Concept Raffia 693

Itec Concept Raffia 697



Itec Concept Bretagne 744



Itec Concept Burgos 730

Itec Concept Camargue 604



Itec Planet Marble 698



Moduleo Impress Country oak 54880

The IVC Group proposes:



- ★ Many smart designs to suit as many tastes
- ★ Made to resist conventional wear and tear
- ★ Tempers sound vibrations and prevents indentations
- ★ Easy to keep in mint condition



- ★ Breathtaking modular designs that allow for unique patterns and variations
- ★ Variety of quick and easy installation methods
- ★ Guaranteed long-lasting quality with commercial warranties up to 10 years
- ★ Minimises risks of slip (R10 rating)



Technical Specifications

modular commercial flooring

MODULEO® TRANSFORM DRYBACK



PRODUCT INFORMATION | INFORMATION PRODUIT | PRODUKTDATEN | PRODUCTINFORMATIE

Level of use Classe d'usage Einstufung Gebruiksklasse	EN ISO 10874	23 - 33 - 42
Total thickness Epaisseur totale Gesamtstärke Totale dikte	EN ISO 24346	2,5 mm (100 mils)
Wear layer Couche d'usure Nuttschicht Slijtlaag	EN ISO 24340	0,55 mm (22 mils)
Wear layer PUR treatment Traitement polyuréthane Oberflächenvergütung PUR slijtlaag behandeling		Protectonite®
Total weight g/m² Poids total g/m² Flächengewicht g/m² Totaal gewicht g/m²	EN ISO 23997	4,059

SIZE & PACKING | DIMENSIONS & EMBALLAGE | ABMESSUNG & VERPACKUNG | FORMAAT & VERPAKKING

Planks A Lames A Dielen A Planken A	EN ISO 24342	19,6 x 132,0 cm (7,72" x 51,97")
Planks B Lames B Dielen B Planken B	EN ISO 24342	24,6 x 149,8 cm (9,69" x 58,98")
Tiles A Dalles A Fliesen A Tegels A	EN ISO 24342	32,9 x 65,9 cm (12,95" x 25,94")
Tiles B Dalles B Fliesen B Tegels B	EN ISO 24342	49,3 x 49,3 cm (19,41" x 19,41")
Box planks A Boîte de lames A Ein Karton Dielen A Doos planken A	14 pcs/box	3,62 m²/box (38,99 ft²/box)
Box planks B Boîte de lames B Ein Karton Dielen B doos planken B	10 pcs/box	3,69 m²/box (39,67 ft²/box)
Box tiles A Boîte de dalles A Ein Karton Fliesen A Doos tegels A	16 pcs/box	3,47 m²/box (37,34 ft²/box)
Box tiles B Boîte de dalles B Ein Karton Fliesen B Doos tegels B	14 pcs/box	3,4 m²/box (36,63 ft²/box)

TEST RESULTS | PERFORMANCES TECHNIQUES | TESTERGEBNISSE | TESTRESULTATEN

Inflammability Classement feu Brandverhalten Brandklasse	EN 13501	Bfl-S1
Scratch resistance Résistance aux rayures Verschleißverhalten Krassvastheid	EN 660-2	Class T
Squareness & straightness Rectitude des arêtes et de l'équerrage Maßstabilität Rechtheid & rechthoekigheid	EN ISO 24342	≤ 0,25 mm (Tiles B) ≤ 0,35 mm (Planks A, B & Tiles A)
Slip resistance Glissance Rutschhemmung Antislip	EN 13893	DS
Slip restraint Résistance au glissement Rutschsicherheit Slipweerstand	DIN 51130	R10
Residual indentation Poinçonnement rémanent Resteindruckverhalten Restindruk	EN ISO 24343-1	Norm: ≤ 0,10mm Average result measured: 0,03mm
Furniture leg resistance Résistance au pied de meuble Möbelschubtest Meubelpoottest	EN ISO 16581	No cracks, no damage
Curling Incurvation Schüsselung Krulling	EN ISO 23999	≤ 2 mm
Electrical resistance Résistance électrique Elektrischer Leitwiderstand Elektrische weerstand	EN 1081	≤ 10 ⁹ Ohm
Dimensional stability Stabilité dimensionnelle Dimensionsstabilität Dimensionele stabiliteit	EN ISO 23999	Norm: ≤ 0,25 % Average result measured: ≤ 0,05 %
Heat insulation Isolation thermique Wärmeleitfähigkeit Thermische isolatie	EN 12524	0,25 w/(m.K)
Thermal resistance R Résistance thermique R Wärmedurchlasswiderstand R Warmtedoorlaatweerstand R	EN ISO 12664	0,0100 m².K/W
Electrostatic performance Accumulation de charges électrostatiques Antistatik Electrostatische propensiteit	EN 1815	< 2 kV
Formaldehyde group Classe formaldehyde Formaldehyd Klassifizierung Formaldehydklasse	EN 717-1	E1
Acoustic insulation Efficacité acoustique Trittschallverbesserungsmaß Kontaktgeluidisolatie	EN 140-8	4 dB
Castor chair resistance Résistance aux chaises à roulettes Stuhlrollenbeanspruchung Bestand tegen stoelwielen	EN 425	No damage to wearlayer, no delamination
Stain resistance Résistance aux taches Fleckenbeständigkeit Vlekbestendigheid	EN ISO 26987	Very good Très bon Sehr gut Zeer goed
Light fastness Résistance à la lumière Lichtechtheit Lichtechtheid	ISO 105-B02	≥6
Underfloor heating Chauffage par le sol Fußbodenheizung Vloerverwarming	EN 12524	Suitable, max 27°C Adapté, max 27°C Geeignet, max 27°C Geschikt, max 27°C
Warranty (year) Garantie (ans) Garantie (Jahre) Garantie (jaar)		20 Residential 10 Commercial

PRODUIT CERTIFIE NF - UPEC



Classement UPEC	U ₃ P ₃ E ₁₂ C ₂
N° Certificat NF UPEC	345-010.1

MODULEO® TRANSFORM CLICK



PRODUCT INFORMATION | INFORMATION PRODUIT | PRODUKTDATEN | PRODUCTINFORMATIE

Level of use Classe d'usage Einstufung Gebruiksklasse	EN ISO 10874	23 - 33 - 42
Total thickness Epaisseur totale Gesamtstärke Totale dikte	EN ISO 24346	4,5 mm (180 mils)
Wear layer Couche d'usure Nuttschicht Slijtlaag	EN ISO 24340	0,55 mm (22 mils)
Wear layer PUR treatment Traitement polyuréthane Oberflächenvergütung PUR slijtlaag behandeling		Protectonite®
Total weight g/m² Poids total g/m² Flächengewicht g/m² Totaal gewicht g/m²	EN ISO 23997	7,681

SIZE & PACKING | DIMENSIONS & EMBALLAGE | ABMESSUNG & VERPACKUNG | FORMAAT & VERPAKKING

Planks A Lames A Dielen A Planken A	EN ISO 24342	19,1 x 131,6 cm (7,52" x 51,81")
Planks B Lames B Dielen B Planken B	EN ISO 24342	24,1 x 149,4 cm (9,49" x 58,82")
Tiles Dalles Fliesen Tegels	EN ISO 24342	32,4 x 65,5 cm (12,76" x 25,79")
Box planks A Boîte de lames A Ein Karton Dielen A Doos planken A	7 pcs/box	1,76 m²/box (18,94 ft²/box)
Box planks B Boîte de lames B Ein Karton Dielen B doos planken B	6 pcs/box	2,16 m²/box (23,25 ft²/box)
Box tiles Boîte de dalles Ein Karton Fliesen Doos tegels	7 pcs/box	1,49 m²/box (15,99 ft²/box)

The warranty covers manufacturing defects and premature wear in the event of normal use | La garantie couvre les vices de fabrication et l'usure précoce en usage normal. | Die Garantie deckt Herstellungsfehler und vorzeitigem Verschleiß bei normaler Nutzung. | De garantie dekt fabricagefouten en voortijdig afslijten bij normaal gebruik.

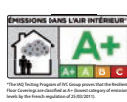



SIZE & PACKING DIMENSIONS & EMBALLAGE ABMESSUNG & VERPACKUNG FORMAAT & VERPAKKING		
Planks Lames Dielen Planken	EN ISO 24342	19,6 x 132,0 cm (7,72" x 51,97")
Box planks Boite de lames Ein Karton Dielen Doos planken	14 pcs/box	3,62 m ² /box (38,99 ft ² /box)

PRODUIT CERTIFIÉ NF - UPEC	
 	
Classement UPEC	U ₃ P ₃ E ₁₂ C ₂
N° Certificat NF UPEC	345-012.1

SIZE & PACKING DIMENSIONS & EMBALLAGE ABMESSUNG & VERPACKUNG FORMAAT & VERPAKKING		
Planks Lames Dielen Planken	EN ISO 24342	19,1 x 131,6 cm (7,52" x 51,81")
Box planks Boite de lames Ein Karton Dielen Doos planken	7 pcs/box	1,76 m³/box (18,94 ft³/box)



Technical Specifications

contract vinyl on rolls

COLLECTIONS		TOTAL THICKNESS	WEAR-LAYER	CLASSIFICATION	HYPERGUARD+	QUICK CLEAN	EASY FIT	ACOUSTICAL BACKING	SLIP RESTRAINT	36+	SANITEC
Isafe one		2.00 mm	0.70 mm	23 - 34 - 43	⊙	⊙	⊙		R11	⊙	
Isafe apex		2.00 mm	0.70 mm	23 - 34 - 43	⊙	⊙	⊙		R11	⊙	
Planet		2.20 mm	0.40 mm	23 - 32	⊙	⊙	⊙		R10		
Atom		2.50 mm	0.70 mm	23 - 34 - 43	⊙	⊙	⊙		R10		
Concept ultimate		2.00 mm	0.70 mm	23 - 34 - 43	⊙	⊙	⊙		R10		⊙
Optimise 50 Optimise 70		3.10 mm 3.40 mm	0.50 mm 0.70 mm	33 - 42 34 - 42	⊙	⊙	⊙	19 dB	R10		⊙
Silento		3.00 mm	0.50 mm	23 - 33	⊙	⊙	⊙	18 dB	R10		
Axento design		3.00 mm	0.50 mm	23 - 33	⊙	⊙	⊙	18 dB	R10		
Axento wood		3.00 mm	0.50 mm	23 - 33	⊙	⊙	⊙	18 dB	R10		
Batirox		3.20 mm	0.30 mm	23 - 31	⊙	⊙	⊙	20 dB	R10		⊙

EN ISO 10874 EXPLAINED



21 - Domestic moderate



31 - Commercial moderate



41 - Light industrial moderate



22 - Domestic general



32 - Commercial general



42 - Light industrial general



23 - Domestic heavy



33 - Commercial heavy



43 - Light industrial heavy



34 - Commercial very heavy



PRODUCT INFORMATION	SAFETY FLOORS	COMMERCIAL DECORATIVE FLOORS			ACOUSTIC FLOORS				
	Isafe	Planet	Atom	Concept	Optimise 50	Optimise 70	Silento	Axento	Batirox
EN ISO 10874 - Level of use	23 - 34 - 43	23 - 32	23 - 34 - 43		33 - 42	34 - 42	23 - 33		23 - 31
EN ISO 24346 - Total thickness	2.00 mm	2.20 mm	2.50 mm	2.00 mm	3.10 mm	3.40 mm	3.00 mm		3.20 mm
EN ISO 24340 - Wear layer	0.70 mm	0.40 mm	0.70 mm		0.50 mm	0.70 mm	0.50 mm		0.30 mm
Wear layer PUR treatment	HyperGuard+®	HyperGuard+®			HyperGuard+®				
Fongi-bacterio static treatment	-	-		Sanitec®	Sanitec®		-		Sanitec®
EN ISO 23997 - Total weight/m²	± 2,850 g	± 2,063 g	± 3,200 g	± 2,949 g	± 2,865 g	± 2,904 g	± 2,198 g		± 2,650 g
Heterogeneous PVC	EN 649	EN 651	EN 649		EN 651				
SIZE & PACKING									
EN ISO 24341 - Width	2 - 4 m	2 - 3 - 4 m	2 - 4 m		2 m		2 - 4 m		2 - 3 - 4 m
EN ISO 26341 - Standard Length	± 25 m	± 30 m	± 25 m		± 25 m				
Weight of standard roll (kg)	± 118-236	± 123-185-246	± 164-328	± 149-298	± 147	± 149	± 114-228		± 136-204-272
TEST RESULTS									
EN 13501 - Inflammability (fully glued)	Bfl-S1	Bfl-S1			Bfl-S1		Cfl-S1		Bfl-S1
EN 13893 - Slip resistance	DS	DS			DS				
DIN 51130 - Slip restraint	R11	R10			R10				
EN ISO 24343-1 - Residual indentation	≤ 0.10 mm	≤ 0.20 mm	≤ 0.10 mm		≤ 0.20 mm				
EN ISO 16581 - Furniture leg resistance	Very good	Very good			Very good				
EN ISO 23999 - Curling	≤ 8 mm	≤ 8 mm			≤ 8 mm				
EN ISO 10965 - Electrical resistance	10º Ohm	10º Ohm			10º Ohm				
EN 1815 - Static electrical propensity	≤ 2kV	≤ 2kV			≤ 2kV				
EN ISO 23999 - Dimensional stability	0.05%	< 0.10%	0.10%	0.05%	0.05%				
ISO 8302 - Thermal insulation	0.0108 m².K/W	0.0195 m².K/W	0.0107 m².K/W	0.0108 m².K/W	-	-	0.0275 m².K/W		-
EN 660-2 - Abrasion group	Groupe T	Groupe T			Groupe T				
EN 717-1 - Fomaldehyde group	E1	E1			E1				
Indoor air quality	Low VOC	Low VOC			Low VOC				
ISO 717-1 - Acoustic insulation	Δ Lw 7 dB	Δ Lw 13 dB	Δ Lw 6 dB	Δ Lw 7 dB	Δ Lw 19 dB		Δ Lw 18 dB		Δ Lw 20 dB
EN 4918 - Castor chair resistance	Very good	Very good			Very good				
ISO 105B02 - Light fastness	6	6 - 7		6	6 - 7				
EN 12524 - Underfloor heating	Suitable	Suitable			Suitable				
EN ISO 26987 - Resistance to chemicals	Very good	Very good			Very good				
Hot welding & Cold welding	Suitable	Suitable			Suitable				



Research & Development Tests

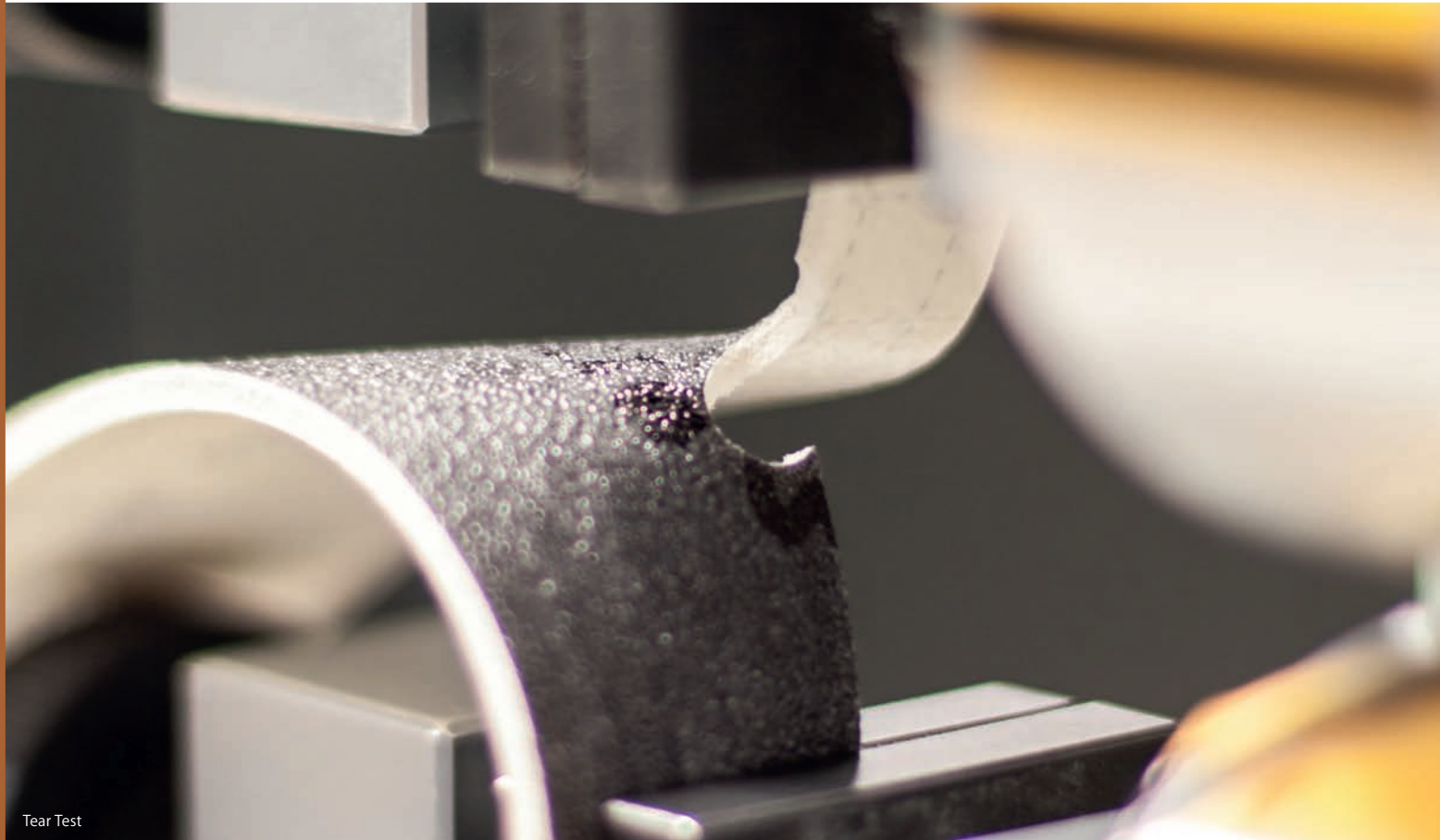

Tear Test

At the IVC Group, we want our floors to be the best they can be. To make absolutely, positively sure that they are, we have put in place a stringent system of testing & quality assurance procedures, which make up a pivotal step in the overall design and development process. Here are some of the rigorous tests conducted in our plants in order to make sure that our customers get the top-quality products they deserve.

In-House Tests

■ Crack Resistance Test

Measures the strength that is required to make the vinyl floor buckle and crack.

■ Delamination Test

Gauges the power of adhesion between different layers by measuring the force needed to tear two layers apart.

■ Residual Indentation Test

Measures the residual indentation and elasticity of our vinyl by controlling its reaction on an exposure to a pressure of 50kg/cm² during a period of 2.5hours.

■ Castor Chair Test

Evaluates the wear and tear resistance of our vinyl floors by unleashing a castor chair and examining changes in the floor's look and stability (25,000 to 50,000 rotations).



Wear Layer Thickness Test

■ Dimensional Stability and Curling Test

Determines whether (or not) the vinyl floor curls, shrinks or expands by first exposing it to a temperature of 80°C and subsequently allowing it to acclimatize to room temperature.



■ Thickness Test

Constant measurements of the thickness of the vinyl in production guarantee that our products continuously stay in line with the European standards.

across the floor vinyl with a pressure of 100kg to see what the damage is.

■ Wear Layer Thickness Test

Measures the thickness of the wear layer using microscopy.

■ Furniture Leg Test

Pits our vinyl against three types of furniture leg, which are dragged



External Tests

■ Ramp Test (slip resistance)

Under controlled conditions, a test person wearing control shoes walks back and forth over the floor covering, whose slope is incrementally increased towards the so-called acceptance angle (the point where the average person would lose his or her footing). Special lubricants are used to mimic specific real-life conditions, like wet or oily floors. This yields a rating from R9 to R11.

■ Surface Roughness Measurement (Rz)

A meter scans the surface of the floor covering in 10 different areas, travelling a 4mm distance and covering five 0.8mm sections in which it measures the highest and lowest point encountered. The Rz value is the average of these and suggests the slip potential of the floor in wet conditions.

■ Pendulum Test

A pendulum, attached to a spring-loaded 'foot' equipped with a standard rubber slider, is made to swing back and forth so that it connects with a dry or wet test floor over a fixed distance. The extent to which the pendulum fails to reach the height of its release (the zero point) on the overswing is used to calculate the slip resistance of the floor. This test is the preferred measurement of the HSE (Health & Safety Executive).





Green Policy



Energy

■ Wind Farm

In 2012 the IVC Group obtained the necessary building and environmental permits for an on-site wind farm. The construction of three turbines started in the spring of 2014. The turbines are up and running since the end of autumn 2014 and transmit the infinite power of the wind to our industrial park in Avelgem, a combined potential that accounts for one-third of the plants' annual energy consumption.

■ Solar Power

In Dalton, Georgia, 454 solar panels, capable of generating a combined per annum total of more than 10,000kWh, provide enough greenjuice to power IVC USA's fleet of electrical lifting trucks, which run on rechargeable batteries. The garden of photovoltaic panels will also create a healthier environment while reducing the plant's overall emission levels, which are already 250% sub industry par. Now that's low.

■ Cooling Water

The IVC Group has invested in an extensive project which uses the surface water from the nearby Scheldt as a coolant. At the production unit in Avelgem, the water which is required as a cooling agent in the manufacturing process is passed through a closed loop circuit. The cold temperature of the river water cools down the semi-finished products at different stages in the manufacturing process, each time preparing them for a next step in production. So far, the results of this project have been very encouraging with a 30% boost in energy efficiency, a significant noise reduction and zero damage to the environment.

■ Energy Recovery

In every one of our plants, we recover and re-use materials, heat and energy in the course of the production process. The IVC Group calls this 'The Big Commute' principle. And we stick by it, every step of the way!

Materials

■ Recycled Resources

Our Moduleo design floors partly consist of recycled materials of a controlled origin. Through postindustrial recycling we are able to distil a particularly 'pure' type of PVC with a very limited impact on the environment.

■ Making our Commitment Click

The Moduleo click system banishes potential contaminants like adhesives from the installation process of the floor and skirting, resulting in a perfect fit with a healthy finish.

Waste Management

■ Waste Water

The plants of the IVC Group do not waste or spill a single drop of H₂O. Water is not only used as a natural coolant in the production cycle, but also as a cleaning product during the stages of printing.

■ Waste Streams

From the get-go in 1997, the IVC Group has made a point of recycling the PVC waste streams generated in the manufacture of its products. Vinyl scraps are salvaged and then pressed into bales, ready to be re-used in a wide variety of applications. All surplus PVC paste is similarly recovered and injected back into the production process of our sheet vinyl.

Curbing Emissions

■ Volatile Organic Compounds

The processing of PVC inevitably releases VOCs, or volatile organic compounds, which can cause damage to the environment. The IVC Group, however, uses suction

and diversion to remove potentially harmful VOC emissions at the source. In Avelgem, the diffusions are rounded up and rerouted into a state-of-the-art condenser, which is able to recoup the bulk of these compounds and re-use them in the production process.

■ Indoor Air Quality

The release of volatile organic compounds is not only confined to the in-house production process of vinyl, but also likely to occur throughout the entire lifespan of building materials. Some products (such as glue, paint, or wooden panels) are liable to emit concentrations of VOCs for prolonged periods of time. The IVC Group has made great strides in counteracting this phenomenon, and in safeguarding the Indoor Air Quality for the

duration of our floors' long and healthy life. This commitment has earned our products the green A+ label, the highest accolade awarded by the French authorities.

■ Water-based inks and PU Coatings

The IVC Group exclusively uses water-based inks for its printing purposes. This decision has completely eliminated the risk of hazardous toxins being released into the air, and markedly reduced our carbon footprint overall.

Moreover, the polyurethane finish that protects our Moduleo floors and keeps them looking fresh is entirely water-based.

Keeping track of our Achievements

■ BRE Ecopoints

All Itec and Moduleo products have been certified by BRE Global, the Building Research Establishment in the UK. In order to acquire this certification, products are submitted to a life-cycle assessment (LCA). Our excellent A+ and A ratings demonstrate the real progress the IVC Group has made in reducing the environmental impact of its products.



Moduleo Transform Latin Pine 24874







Want to learn more about our efforts? Take a look at our Corporate Responsibility brochure.



Meeting International Standards & Norms

Certificate / Label	What it means	Our achievement
BRE 	BRE (British Research Establishment) subjects products to a full life cycle assessment, that examines the environmental impact associated with the individual stages in a product's life from cradle to grave.	Moduleo and Itec products achieve excellent A+ and A ratings.
CE EN 14041:2004 	EN 14041:2004 details the requirements for CE marking of textile, laminate and resilient floor coverings.	The IVC Group's products outperform the proviso for E1 CE-conformity by a factor of 10.
FSC 	The Forest Stewardship Council (FSC), is a non-profit organization that sets certain high standards to make sure that forestry is practiced in an environmentally responsible and socially beneficial manner.	If you get a letter or brochure from us, you can bet it's printed on FSC-approved paper.
DIBt/AgBB 	DIBt is by far the most unforgiving interpretation of the European directive for the safe and sustainable use of construction products.	All our vinyl products satisfy the stringent emission criteria as stipulated by the renowned DIBt Institute.
Émissions dans l'air intérieur Indoor Air Quality 	Construction products, decoration and furnishing products to be traded in France for the first time are to be labelled with the 'Émissions dans l'air intérieur' classification on the basis of VOC emissions tests.	Itec and Moduleo carry the green A+ label.

Certificate / Label	What it means	Our achievement
Floorscore 	<p>FloorScore® was developed by the Resilient Floor Covering Institute (RFCI) together with Scientific Certification Systems (SCS) to test and certify flooring products for compliance with the volatile organic compound emissions criteria of the California Section 01350 standard.</p>	<p>Moduleo's luxury vinyl planks and tiles have obtained an excellent FloorScore that qualifies them for use in public spaces such as schools and healthcare facilities.</p>
ISO 9001:2008 	<p>The ISO 9000 family standards provide guidance and tools for companies and organizations who want to ensure that their products and services consistently meet customer's requirements, and that quality is consistently improved. ISO 9001:2008 sets out the requirements of a quality management system.</p>	<p>The IVC Group is ISO 9001 certified in all our production sites worldwide.</p>
ISO 14001 	<p>This official seal of approval refers to the international standard in environmental management systems and lets everyone know that a company is actually living up to its ecological promises and policies.</p>	<p>The Environmental Management Systems of Balterio, Spanolux and IVC NV in Avelgem are ISO 14001 certified.</p>
REACH 	<p>REACH, the Regulation on Registration, Evaluation, Authorisation and Restriction of Chemicals, aims to ensure a high level of protection of human health and the environment from the risks that can be posed by chemicals, the promotion of alternative test methods and the free circulation of substances on the internal market.</p>	<p>The IVC Group carefully vets the raw materials we buy and process, making sure that they do not contain suspect or potentially harmful substances.</p>
Recovynil Plus 	<p>Recovynil works as a neutral mediator between recyclers and converters. Its role is to certify the quality and volume of recycled PVC being put in the market by its recycling partners and to certify the volume of recycled PVC used by its converting partners on new products.</p>	<p>The IVC recycling plant in Avelgem is audited and certified under the Eucertplast Scheme for European Plastic Recyclers. The Recovynil Plus certificate of compliance is awarded.</p>



Dedicated customer service

Do you have any questions? We are pleased to help you and give you more information on our products and special offers.

www.ivcgroup.com

Contact us

BELGIUM

Nijverheidslaan 29
B-8580 Avelgem
T +32 56 65 32 11
F +32 56 65 32 29
projectsbelux@ivcgroup.com
www.ivcgroup.com

UK

23 Royal Scot Road
Pride Park
Derby DE24 8AJ
T +44 1332 8515 00
F +44 1332 8515 01
info@moduleo.co.uk
info@itecfloors.co.uk
www.moduleo.co.uk
www.itecfloors.co.uk

GERMANY

Reisholzer Werftstrasse 33
40589 Düsseldorf
T +49 211 598 930 00
F +49 211 598 930 01
info@moduleo.de
info@itecfloors.com
www.moduleo.de